

MEDIUM DUTY TRUSS
20.5" x 20.5" PLATED

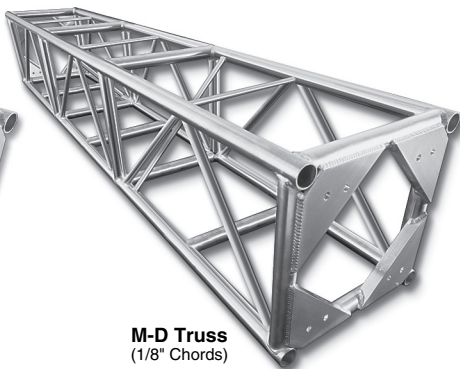

"Studio" M-D Truss
 (3/16" Chords)



M-D Truss
 (1/8" Chords)

- * **Standard lengths are 10', 8' and 5'**
- * **Custom lengths available upon request**

- Equipped with single Camlocs or bolts
- Available with double Camlocs
- Available with casters
- Diagonals are 1" OD x 1/8" aluminum
- Fabricated by certified welders

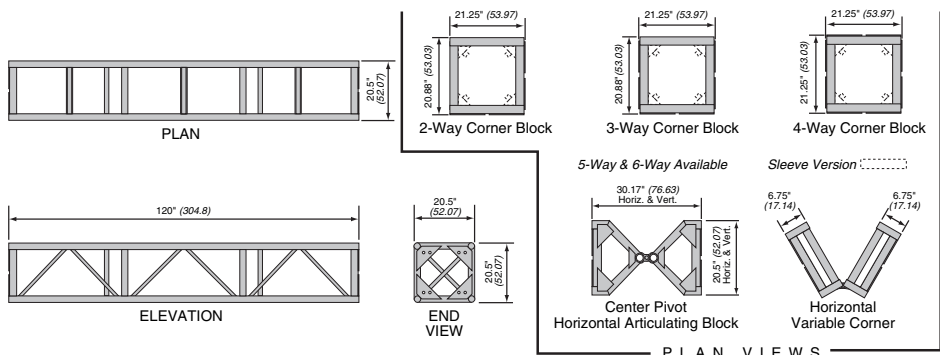

ALLOWABLE LOAD DATA

MEDIUM DUTY TRUSS 20.5" x 20.5" PLATED

Span ft. (mtrs)	MAXIMUM ALLOWABLE UNIFORM LOADS			MAXIMUM ALLOWABLE POINT LOADS					
				CENTER POINT		THIRD POINT		QUARTER POINT	
	Load #/ft.	Load lbs (kgs)	Max Defl. in.	Load lbs (kgs)	Max Defl. in.	Load lbs (kgs)	Max Defl. in.	Load lbs (kgs)	Max Defl. in.
<i>Single Camloc through 3/8" gusset plates</i>									
10 (3.04)	658	6580 (2985)	0.06	3292 (1493)	0.05	2469 (1120)	0.06	1646 (747)	0.06
20 (6.09)	157	3140 (1424)	0.24	1580 (717)	0.19	1185 (538)	0.24	790 (358)	0.23
30 (9.14)	65	1950 (885)	0.53	980 (445)	0.44	735 (333)	0.54	490 (222)	0.51
40 (12.21)	32	1280 (581)	0.93	658 (298)	0.80	493 (224)	0.97	329 (149)	0.91
50 (15.24)	17	850 (386)	1.43	447 (203)	1.28	335 (152)	1.50	223 (101)	1.43
<i>Two Camlocs through 3/8" gusset plates</i>									
10 (3.04)	839	8390 (3806)	0.08	5336 (2420)	0.08	4002 (1815)	0.10	2668 (1210)	0.09
20 (6.09)	260	5200 (2359)	0.38	2602 (1180)	0.31	1951 (885)	0.39	1301 (590)	0.36
30 (9.14)	110	3300 (1497)	0.86	1661 (753)	0.70	1246 (565)	0.88	831 (377)	0.82
40 (12.21)	58	2320 (1052)	1.52	1169 (530)	1.26	876 (397)	1.56	584 (265)	1.46
50 (15.24)	34	1700 (771)	2.38	856 (388)	2.01	642 (291)	2.43	428 (194)	2.30
<i>5/8" Diameter Grade 8 bolts with standard washers through 3/8" gusset plates</i>									
10 (3.04)	839	8390 (3806)	0.08	4744 (2152)	0.07	3558 (1614)	0.09	2372 (1076)	0.08
20 (6.09)	230	4600 (2087)	0.34	2306 (1046)	0.27	1729 (784)	0.35	1153 (523)	0.32
30 (9.14)	97	2910 (1320)	0.76	1464 (664)	0.62	1098 (498)	0.78	732 (332)	0.73
40 (12.21)	51	2040 (925)	1.36	1021 (463)	1.13	765 (347)	1.39	510 (231)	1.30
50 (15.24)	29	1450 (658)	2.10	737 (334)	1.80	553 (251)	2.16	369 (167)	2.05

Note: Deflections reported in the above tables are maximum expected for full loadings (indoors only).

All loads are based on 10'-0" sections. Other section lengths are available.

Load tables are reprinted from engineering reports developed by Parkhill, Smith & Cooper, Inc., structural engineers, and apply to truss fabricated after December, 1989.

MEDIUM DUTY TRUSS 20.5" x 20.5" PLATED

End plates equipped for double sets of bolts or Camlocs, supplied with one set only

Product Description	Item Code	Weight lbs (kgs)
5' MEDIUM DUTY TRUSS	Bolt TRS 2020-060B Cam TRS 2020-060C	56 (25)
8' MEDIUM DUTY TRUSS	Bolt TRS 2020-096B Cam TRS 2020-096C	77 (35)
10' MEDIUM DUTY TRUSS	Bolt TRS 2020-120B Cam TRS 2020-120C	85 (39)
MEDIUM DUTY 2-WAY CORNER	Bolt TRS 2020-C2B Cam TRS 2020-C2C	31 (14)
MEDIUM DUTY 3-WAY CORNER	Bolt TRS 2020-C3B Cam TRS 2020-C3C	32 (15)
MEDIUM DUTY 4-WAY CORNER	Bolt TRS 2020-C4B Cam TRS 2020-C4C	39 (18)
MEDIUM DUTY 5-WAY CORNER	Bolt TRS 2020-C5B Cam TRS 2020-C5C	52 (24)
MEDIUM DUTY 6-WAY CORNER	Bolt TRS 2020-C6B Cam TRS 2020-C6C	58 (27)

Product Description	Item Code	Weight lbs (kgs)
5' MEDIUM DUTY TRUSS (Studio)	Bolt TRS 20ST-060B Cam TRS 20ST-060C	66 (30)
8' MEDIUM DUTY TRUSS (Studio)	Bolt TRS 20ST-096B Cam TRS 20ST-096C	91 (42)
10' MEDIUM DUTY TRUSS (Studio)	Bolt TRS 20ST-120B Cam TRS 20ST-120C	102 (47)
MD ARTICULATING BLOCK HORIZONTAL (center pivot)	Bolt TRS 2020-AHB Cam TRS 2020-AHC	59 (27)
MD ARTICULATING BLOCK VERTICAL (center pivot)	Bolt TRS 2020-AVB Cam TRS 2020-AVC	59 (27)
MD VARIABLE CORNER HORIZ. (book style with brace)	Bolt TRS 2020-VHB Cam TRS 2020-VHC	45 (21)
MD VARIABLE CORNER VERT. (book style with brace)	Bolt TRS 2020-VVB Cam TRS 2020-VVC	45 (21)
MD 2-WAY SLEEVE FOR 12" TOWER	Bolt TRS 2020-S2B Cam TRS 2020-S2C	43 (20)
MD 3-WAY SLEEVE FOR 12" TOWER	Bolt TRS 2020-S3B Cam TRS 2020-S3C	50 (23)
MD 4-WAY SLEEVE FOR 12" TOWER	Bolt TRS 2020-S4B Cam TRS 2020-S4C	56 (26)